

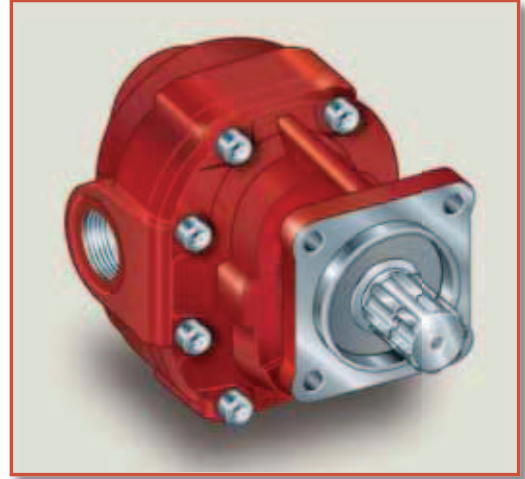

Hydrocar
Hydraulic Energy

FZH

Gear Pump



ORDERING CODE

200 FZH 075 ^D/_S S

GEAR PUMP

TYPE

DISPLACEMENT

ROTATION
D = CLOCKWISE
S = ANTICLOCKWISE

DIN 5462

DIN FZH 75
5 4 6 2 FZH 85
SE FZH 100
FZH 116
FZH 130
FZH 150

SPECIFICATIONS AND TECHNICAL DATA

TYPE	CODE	DISPLACEMENT cm ³ /rev.	A mm	B mm	C INLET	D OUTLET	WEIGHT kg
FZH 75	200FZH075 ^D / _S S	73	127.5	194.5	1" 1/4 G	1" G	18
FZH 85	200FZH085 ^D / _S S	84	130	198.5	1" 1/4 G	1" G	18.9
FZH 100	200FZH100 ^D / _S S	100	139.5	204.5	1" 1/4 G	1" G	19.8
FZH 116	200FZH116 ^D / _S S	116	139.5	210.5	1" 1/4 G	1" G	20.7
FZH 130	200FZH130 ^D / _S S	132	135.5	216.5	1" 1/2 G	1" G	21.6
FZH 150	200FZH150 ^D / _S S	148	143.5	222.5	1" 1/2 G	1" G	22.5

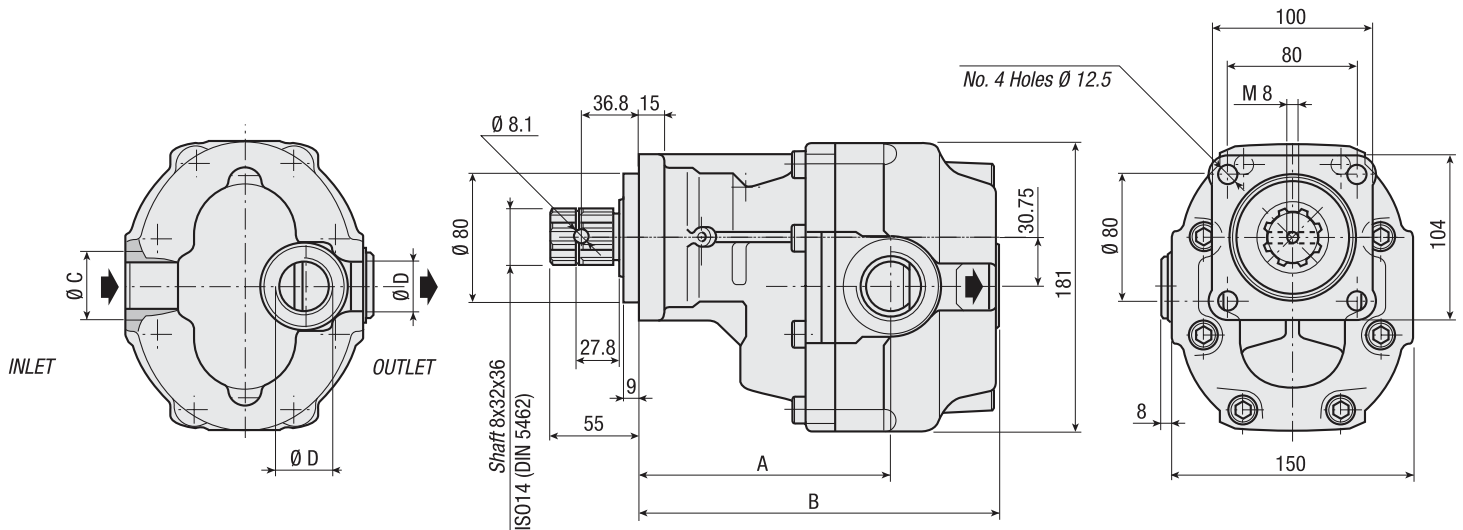

**TRANSPORT
HYDRAULIC
SOLUTIONS**

TM

FREEPHONE

New Zealand **0800 22 55 69**

Australia **1800 22 55 69**

INNOVATION IN MOTION

www.transporthydraulics.com

EXAMPLE OF WORKING CYCLES

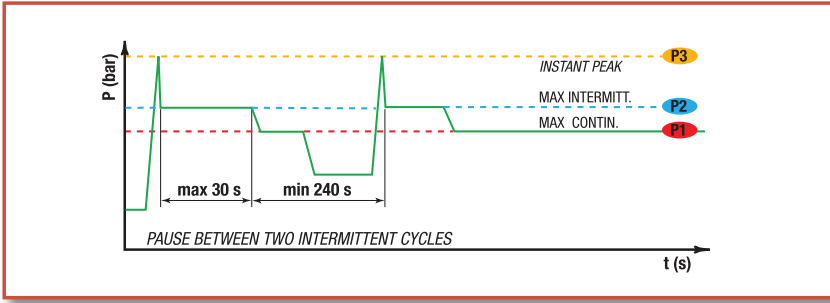

Inlet pressure:	0.7 ÷ 1.5 bar (absolute)
Operating viscosity range:	12 ÷ 100 cSt
Fluid temperature °C (t):	-10° + 80° C

Working Press. P2	Contamination		Filter $\beta_x = 75$
	NAS 1638	ISO 4406	
≤ 200 bar	12	21/18	40 μ m
≥ 200 bar	11	20/17	25 μ m

◀ RECOMMENDED FILTERING (return or outlet)

TYPE			FZH75	FZH85	FZH100	FZH116	FZH130	FZH150
Displacement	Vg	cm ³ /n cm ³ /rev.	73	84	100	116	132	148
Max continuous operating pressure	P1	bar	300	270	260	250	230	190
Max intermitt. operat. press. (max 30 s)	P2		320	310	290	280	270	230
Max peak pressure (≤ 0.1 s)	P3		450	375	375	340	315	270
Max intermittent speed (P ≤ 20 bar)	n3	n/min r.p.m.	3800	3500	3500	3000	3000	3000
Max continuous speed (≤ P1)	n1		1800	1800	1500	1500	1500	1500
Min intermittent speed (≤ P2 x 0.5) (max 30 s)	n4		300	300	250	250	250	250

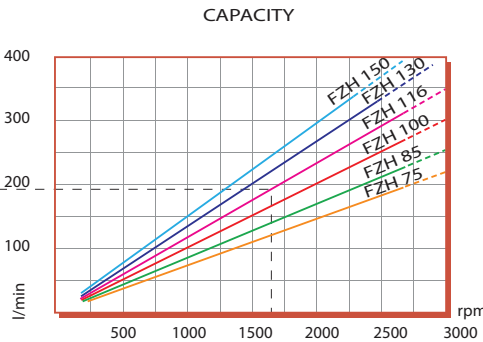
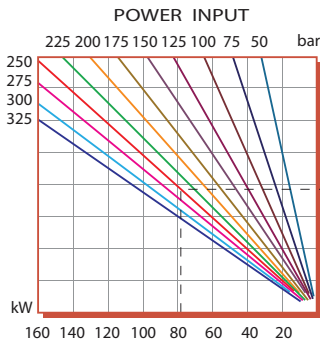

DIAGRAMS

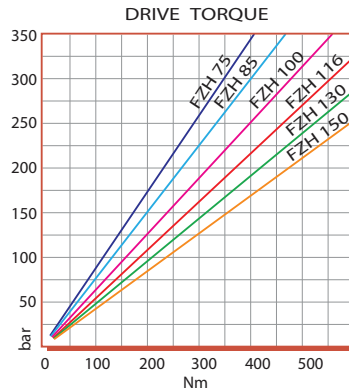
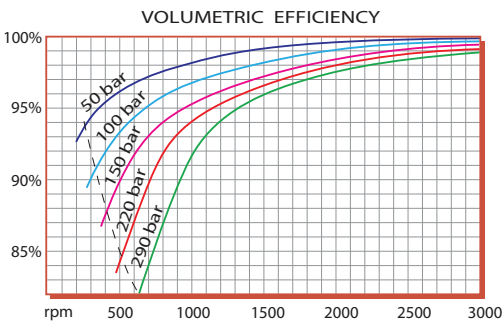

THE ABOVE SPECIFICATIONS REFER TO OIL TYPE ISO VG 46 AT 50° C ($\nu=30$ cSt)

GEAR PUMPS