

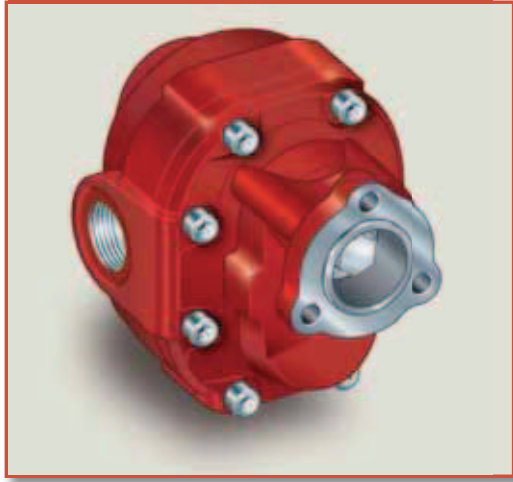

Hydrocar
Hydraulic Energy

FZH

Gear Pump



ORDERING CODE
 200 FZH 075 ^D 0
 | | | |
 | | | | 21 UNI 222
 | | | | ROTATION
 | | | | D = CLOCKWISE
 | | | | S = ANTICLOCKWISE
 | | | DISPLACEMENT
 | | TYPE
 | GEAR PUMP

- UNI**
21-222
- FZH 75
 - FZH 85
 - FZH 100
 - FZH 116
 - FZH 130
 - FZH 150

SPECIFICATIONS AND TECHNICAL DATA

TYPE	CODE	DISPLACEMENT cm ³ /rev.	A mm	B mm	C INLET	D OUTLET	WEIGHT kg
FZH 75	200FZH075 ^D 0	73	127	194	1" 1/4 G	1" G	16.3
FZH 85	200FZH085 ^D 0	84	129.5	198	1" 1/4 G	1" G	17.2
FZH 100	200FZH100 ^D 0	100	139	204	1" 1/4 G	1" G	18.1
FZH 116	200FZH116 ^D 0	116	139	210	1" 1/4 G	1" G	19
FZH 130	200FZH130 ^D 0	132	135	216	1" 1/2 G	1" G	19.9
FZH 150	200FZH150 ^D 0	148	143	222	1" 1/2 G	1" G	20.8

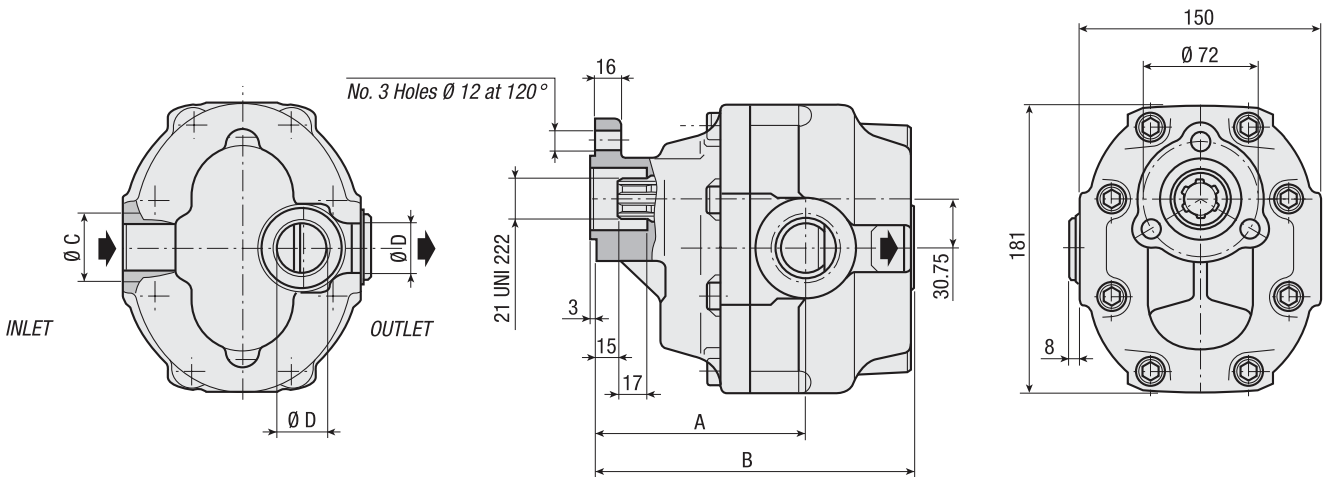

TM

TRANSPORT
HYDRAULIC
SOLUTIONS

INNOVATION IN MOTION

FREEPHONE

New Zealand **0800 22 55 69**

Australia **1800 22 55 69**

www.transporthydraulics.com

TECHNICAL DATA

EXAMPLE OF WORKING CYCLES

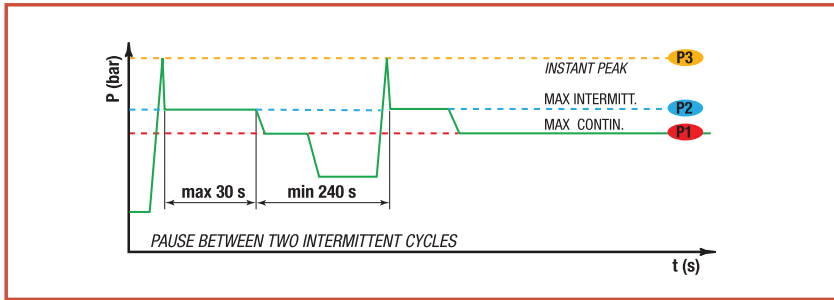

Inlet pressure:	0.7 ÷ 1.5 bar (absolute)
Operating viscosity range:	12 ÷ 100 cSt
Fluid temperature °C (t):	-10° + 80° C

Working Press. P2	Contamination		Filter $\beta_x = 75$
	NAS 1638	ISO 4406	
≤ 200 bar	12	21/18	40 μ m
≥ 200 bar	11	20/17	25 μ m

◀ RECOMMENDED FILTERING (return or outlet)

TYPE				FZH75	FZH85	FZH100	FZH116	FZH130	FZH150
Displacement	Vg	cm ³ /n	cm ³ /rev.	73	84	100	116	132	148
Max continuous operating pressure	P1			300	250	250	240	210	180
Max intermitt. operat. press. (max 30 s)	P2	bar		320	280	270	260	210	180
Max peak pressure (≤ 0.1 s)	P3			450	375	375	340	315	270
Max intermittent speed (P ≤ 20 bar)	n3			3800	3500	3500	3000	3000	3000
Max continuous speed (≤ P1)	n1	n/min	r.p.m.	1800	1800	1500	1500	1500	1500
Min intermittent speed (≤ P2 x 0.5) (max 30 s)	n4			300	300	250	250	250	250

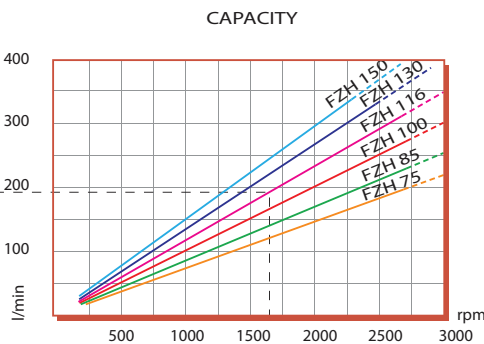
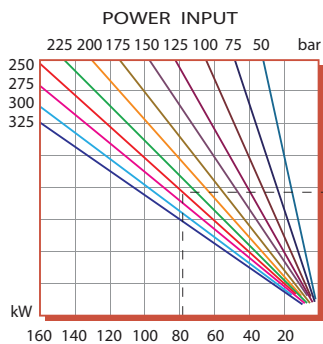

DIAGRAMS

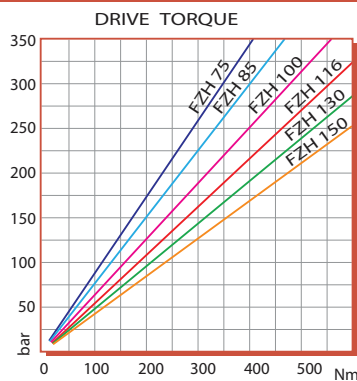
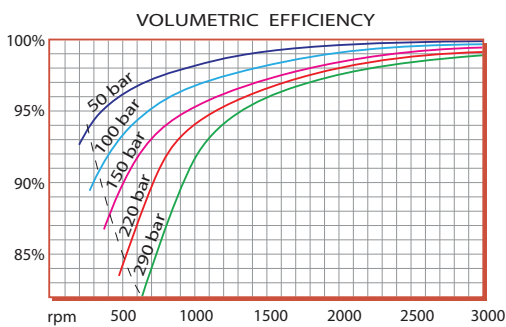

THE ABOVE SPECIFICATIONS REFER TO OIL TYPE ISO VG 46 AT 50° C ($\nu=30$ cSt)

GEAR PUMPS



TRANSPORT HYDRAULIC SOLUTIONS

INNOVATION IN MOTION



FREEPHONE

New Zealand **0800 22 55 69**

Australia **1800 22 55 69**

www.transporthydraulics.com