

**gigant**   
the driving force

## **17.5 Low-Loader**

- **10 Stud 225 pcd**
- **Compact Bearing**
- **300 x 200 Brake**
- **ABS/EBS Sensor Standard**
- **Auto Slack Adjustor**
- **Outboard Mounted Drum**



Contact us for pricing and enquiries

Free Call Now

NZ 0800 22-55-69 AU 1800-22-55-69



**THS**

**TRANSPORT  
HYDRAULIC  
SOLUTIONS**

[www.transporthydraulics.com](http://www.transporthydraulics.com)

# GKH2 105 TKLRM 50/9.1

ride height FH: 196-236 mm

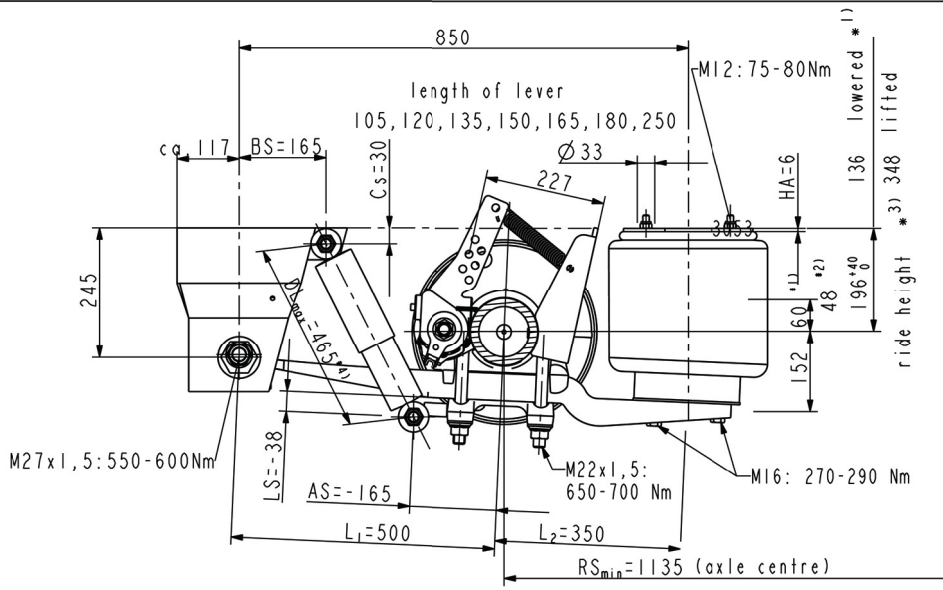

direction of travel

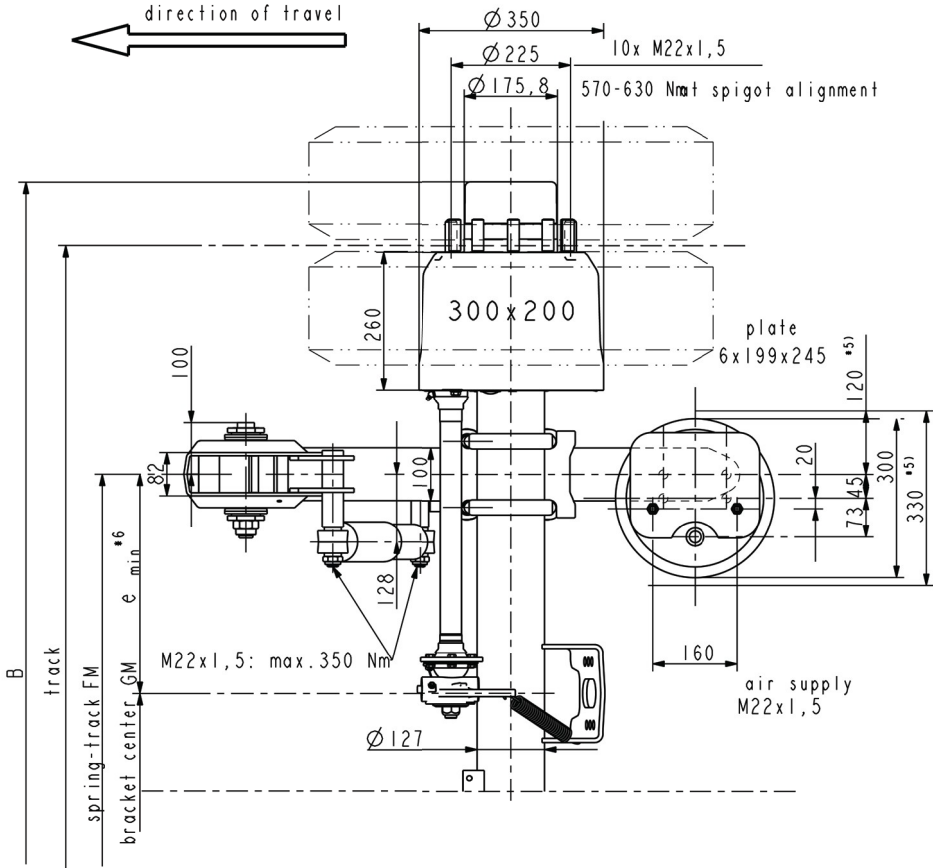

## axle load:

max. 9000 kg at 105 km/h

(depend on spring track and centre of gravity height)

lift in total: 200 mm at  $FH_{OL}^{*2)}$

- \* 1) laden, without air
- \* 2) unladen, without air
- \* 3)  $FH_{Lift}=248$  mm  
minimum acceptable height with axle lift
- \* 4) Just for raising and lowering (HS) locking valve to be adjusted that air supply is stopped at  $DL_{max}=465$ .
- \* 5) space requirement
- \* 6)  $e_{min}$  for brake-cylinder 30 = 280mm  
for tristop-cylinder = 315mm

## Recommendation side support

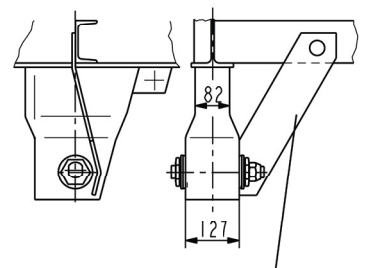

not part of normal delivery

test report: TDB 0574

No.	track	GM	B	FM	order no.		weight kg ( $\pm 2\%$ )	recommendation for twin mount
					AGS	ABS+AGS		
1	1875	269	2117	965	5 105 7 139	5 105 7 140	448	245/70 R17,5 *
2								
3								
4								
5								
6								
7								
8								
9								

OBSERVE INSTALLATION INSTRUCTIONS !!!

**gigant**

TRENKAMP & GEHLE GmbH  
D-49413 Dinklage

\* Take care of sufficient tyre load capacity

Draw.-no.: 9915-441

Index  
0